

Based on Ordnance Survey mapping with the permission of the Controller of Her Majesty's Stationery Office. © Crown copyright. Unauthorised reproduction infringes Crown copyright and may lead to prosecution or civil proceedings.
Lancashire County Council Licence No. LA100023320

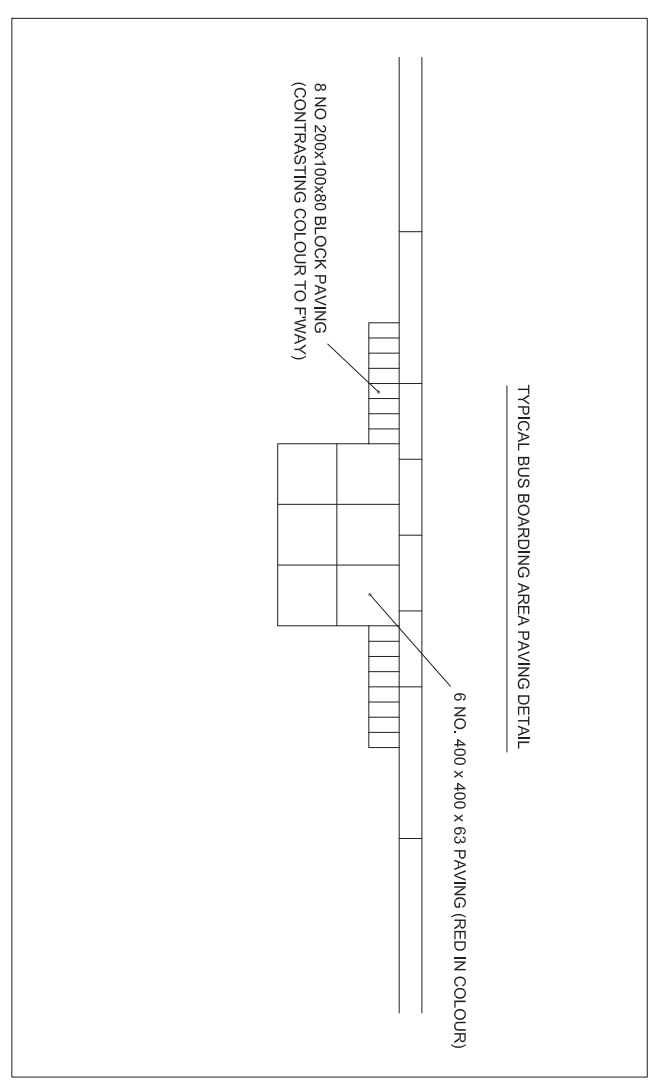

KEY TO SURFACING

- RESURFACE EXISTING FOOTWAY (209m²)
(Footway gullies re-levelled and gratings replaced with cycle friendly variant)
- FOOTWAY BUILD OUT (58m²)
- RED MMA COLOURED SCREED (145m²)
- NEW FOOTWAY AREA OVER VERGE (10m²)

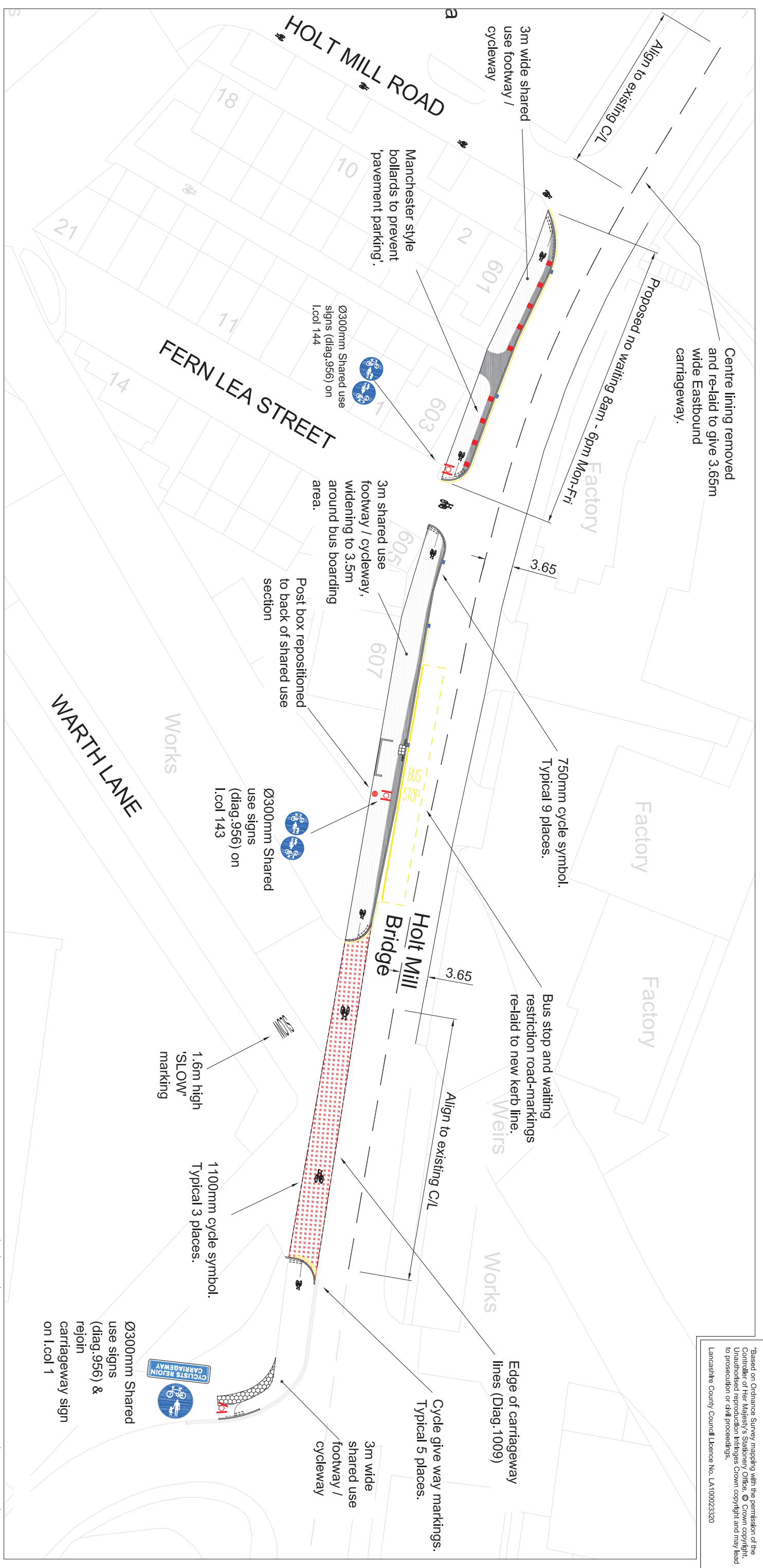
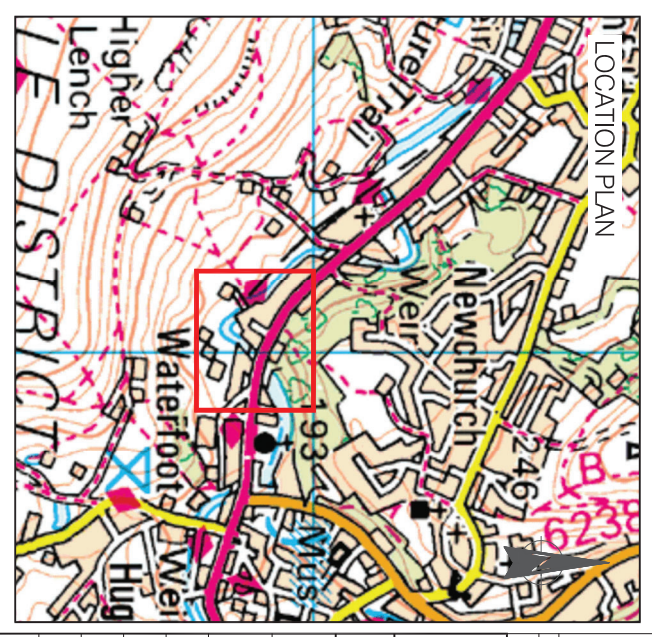

<p>Lancashire County Council</p> <p>Design and Construction</p>				
PROJECT TITLE	FAST LANCASHIRE CYCLEWAY VALLEY OF STONE - SECTION 03			
DRAWING TITLE	BUCKHURST PLANT GAP BACUP ROAD - GENERAL ARRANGEMENT			
DRAWN BY	J BARON			
CHECKED BY	T LUND			
APPROVED BY	JUN 2022			
PROJECT No.	CHM21MW226			
DRAWING No.	VOS-03-007			
SCALE @ A1	1:500			
SHEET No.	1 OF 1			
CLIENT No.	CHM21MW226			
ISSUE PURPOSE	CONSULTATION			
NO.	DATE	AMENDMENT DETAILS	CHECKED BY	DRAWN BY
C	JUNE 22	SHARED USE WIDTH VARIED TO ACCOMMODATE PART-TIME RESTRICTIONS	T LUND	J BARON
<p>REVISIONS</p>				